

VISITOR GUIDE

**COOPER
HEWITT**

 Smithsonian Design Museum



WELCOME TO COOPER HEWITT, SMITHSONIAN DESIGN MUSEUM

We invite you to discover the importance of design and its power to change the world.

Masks are welcome but not required.

HOURS OF OPERATION

MUSEUM, SHOP, GARDEN, AND CAFE

Daily 10 a.m.–6 p.m.

PUBLIC TOURS

Hector Guimard: How Paris Got Its Curves Tour
Sunday, Tuesday, and Thursday, 1:30 p.m.

Andrew Carnegie Mansion Tour
Monday, Wednesday, *Friday, and Saturday, 1:30 p.m.

* The first and third Friday of each month the Andrew Carnegie Mansion tour will be replaced by a special Curator Tour.

ADMISSION

Please have your ticket ready to be scanned at the accessible entrance at 2 East 91st Street. Tickets are not required to visit the Garden, cafe, and SHOP Cooper Hewitt.

Adults	\$15
Seniors (62 and above)	\$9
Visitors with Disability	\$9
Students (with ID)	\$9
18 and under	Free
Museum Members	Free
Guest of Museum Members	\$9

Pay What You Wish, Daily, 5–6 p.m.

Reserve your tickets online at cooperhewitt.org

@cooperhewitt
#CooperHewitt



1 FLOOR

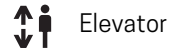

Elevator



Restroom



Tickets



Temporarily closed

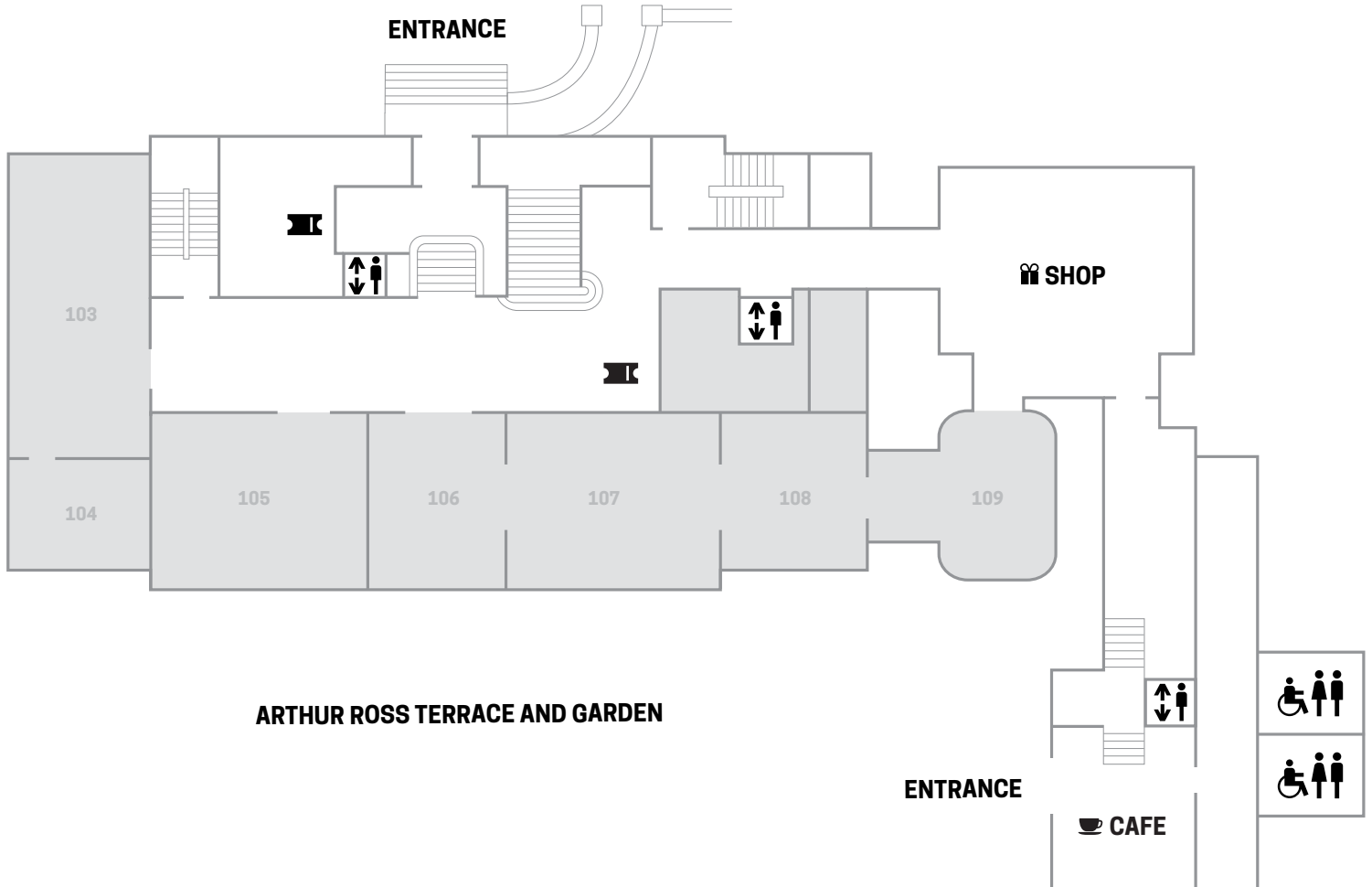

ARTHUR ROSS TERRACE AND GARDEN

ENTRANCE

CAFE

SHOP

UPCOMING



GIVE ME A SIGN: THE LANGUAGE OF SYMBOLS

Opens May 13, 2023

Galleries 105-109

Give Me a Sign will feature never-before-seen material from Cooper Hewitt's Henry Dreyfuss Archive. Discover the history behind many symbols and participate in creative activities in-gallery and online to co-create a Symbol Sourcebook of 2024.

2 FLOOR

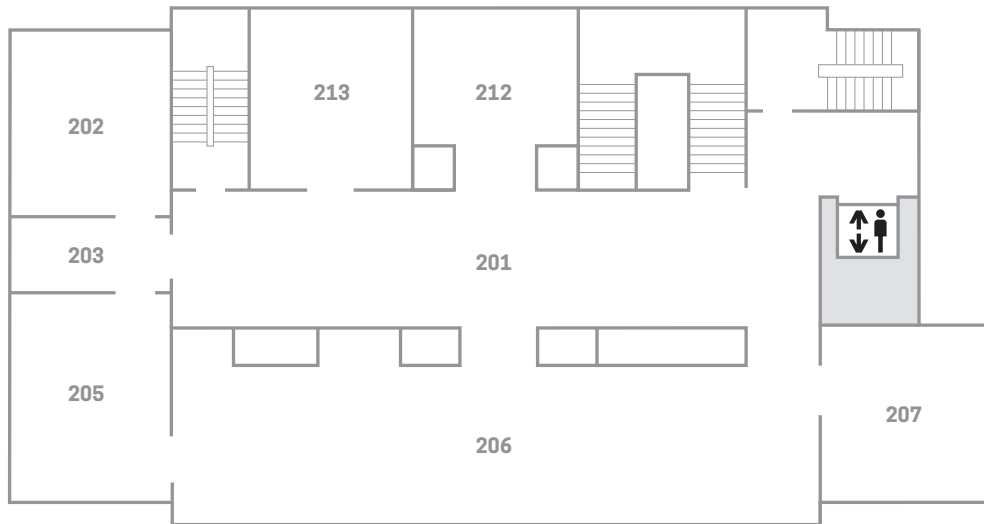

DECONSTRUCTING POWER: W. E. B. DU BOIS AT THE 1900 WORLD'S FAIR

Through May 29, 2023

Galleries 201 and 213

This exhibition places decorative arts from Cooper Hewitt's permanent collection in dialogue with 20 innovative data visualizations created for the 1900 Paris World's Fair by W. E. B. Du Bois (1868–1963) to explore how design can both reveal and mask dynamics of power and equity.



HECTOR GUIMARD: HOW PARIS GOT ITS CURVES

Through May 21, 2023

Galleries 202, 203, 205, and 206

This exhibition invites a new understanding of France's most famous Art Nouveau architect, Hector Guimard (1867–1942). Best known for his iconic Paris Métro entrances, this exhibition will provide urban and historical context for the full range of Guimard's design work.



IMMERSION ROOM

Ongoing

Gallery 207

Design your own wallpaper and see it projected on the walls from floor to ceiling.



BOTANICAL LESSONS

Through March 31, 2023

Gallery 212

Explore nature in the Smithsonian collections through thirteen botanical models and a selection of illustrated books and periodicals.



CARNEGIE MANSION

Cooper Hewitt is housed in the former home of industrial magnate and philanthropist Andrew Carnegie and his family. Completed in 1902, the mansion was designed in the style of an English Georgian country house.



Learn more about the building that Cooper Hewitt calls home. Book available for purchase.

shop.cooperhewitt.org

3 FLOOR

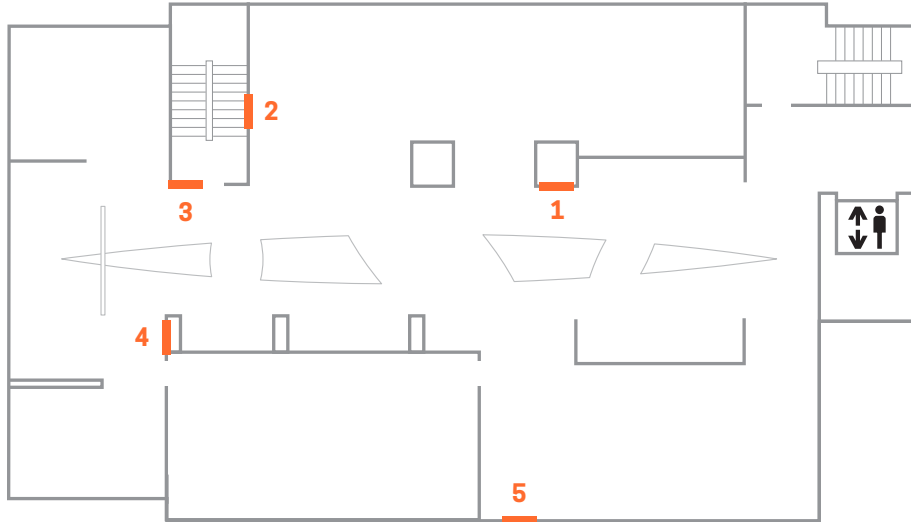

FIVE QUESTIONS

- 1 How can design engage creative confrontation?
- 2 How can design help transitions from instability to peace?
- 3 How can design support safe, healthy, respectful environments?
- 4 How can design embrace truth and dignity in a search for peace and justice?
- 5 How can design address the root causes of conflict?



DESIGNING PEACE

Through August 6, 2023

Designing Peace explores the unique role design can play in pursuing peace. The exhibition features design projects from around the world that look at ways to create and sustain more durable peaceful interactions—from creative confrontations that challenge existing structures to designs that demand embracing justice and truth in a search for reconciliation.

GROUND FLOOR

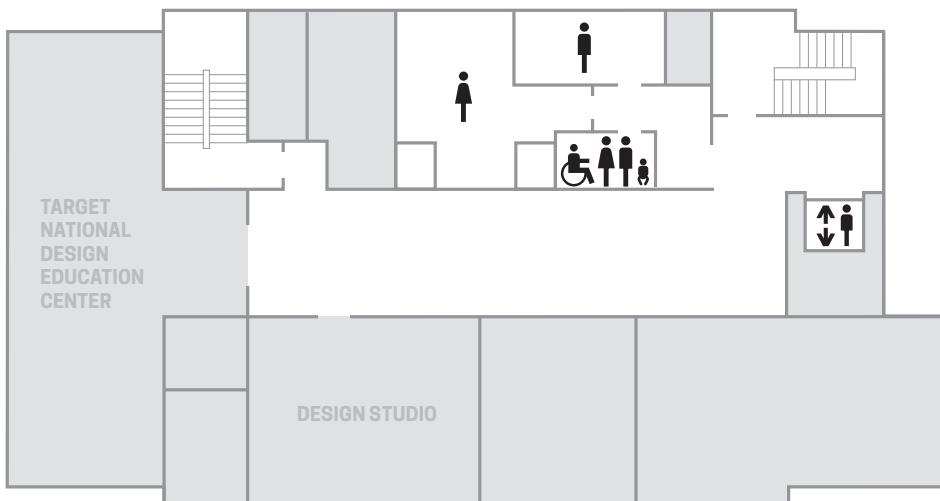

NATIONAL HIGH SCHOOL DESIGN COMPETITION

A poster exhibition of project entries from Cooper Hewitt's annual National High School Design Competition, which for 2022 challenged students to design for a more peaceful and just world.